

# MODEL OF46HD

- Wirewound
- Bushingmount
- Servomount
- RoHS Compliant

## ● Standard Dimensions



Model OF46HD-10

### ■ Bushingmount Type

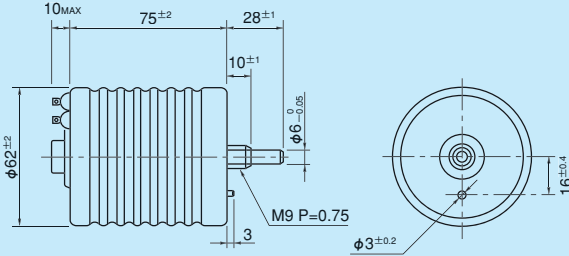

Note: 1 pc. inner teeth washer and 2 pcs. hex nuts are attached.

### ■ Servomount Type

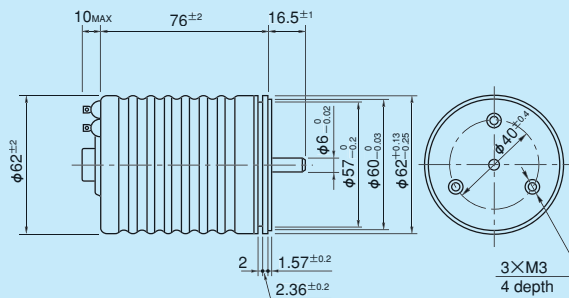

## ● Standard Model Numbers

Bushingmount type	
10-turn models	OF46HD-10
Servomount type	
10-turn models	OF46HDS-10

## ● General Specifications

<b>Standard Resistance Range</b>	100,200,500,1k,2k,5k,10k,20k,50k,100kΩ
<b>Max. Practical Resistance</b>	200kΩ
<b>Total Resistance Tolerance</b>	Standard Class ±3% (H) (±5% (J) in case of within 1kΩ) Precision Class ±1% (F)
<b>Independent Linearity Tolerance</b>	Standard Class ±0.3% Precision Class ±0.1% (±0.15% in case of within 5kΩ)
<b>Power Rating</b>	5.0W

<b>Noise</b>	Within 100Ω E.N.R.
<b>Electrical Travel</b>	3,600° ±5°
<b>Mechanical Travel</b>	3,600° <sup>+10°</sup> <sub>σ</sub>
<b>Insulation Resistance</b>	Over 100MΩ at 1,000V.D.C.
<b>Dielectric Strength</b>	1 minute at 1,000V.A.C.
<b>Starting Torque</b>	Within 30mN · m (300gf · cm)
<b>Stopper Strength</b>	Approx. 0.9N · m (9kgf · cm)
<b>Resistance Temperature Coefficient</b>	±20p.p.m./°C
<b>Mass</b>	Approx. 290g

## ● Standard Resistance Values ■ No. of Wire Turns ■ Resistance Wire Used

Resist. Value (Ω)	100	200	500	1k	2k	5k	10k	20k	50k	100k	※ 200k
No. of Wire Turns	2,500	3,180	4,350	5,400	6,850	6,660	8,550	10,850	14,900	18,850	24,390
Resist. Wire Used	Cu-Ni					Ni-Cr					

Note: Mark ※ shows special high resistance value.

## ● Special Specifications Available

(In the case of the potentiometer with special specifications, the general specifications and environmental specifications may change. Please consult us in advance.)

- Multi-ganged (Available up to 2 gangs. Please note that mounting method is changed from bushingmount to screw-mounting)
- With limit-switches ● 3-turn and 5-turn type (These housing lengths are the same as that of 10-turn type: 75±2mm)
- Shaft dia. (φ 6.35mm) & bushing with inch dimension ● Special machining on the shaft
- Shaft with front and rear extension (Rear shaft with 6mm dia. and 28mm length)