

MODEL FCP12AC

- Conductive Plastic
- Bushingmount
- Low-cost Item
- RoHS Compliant



Model FCP12AC

Standard Dimensions

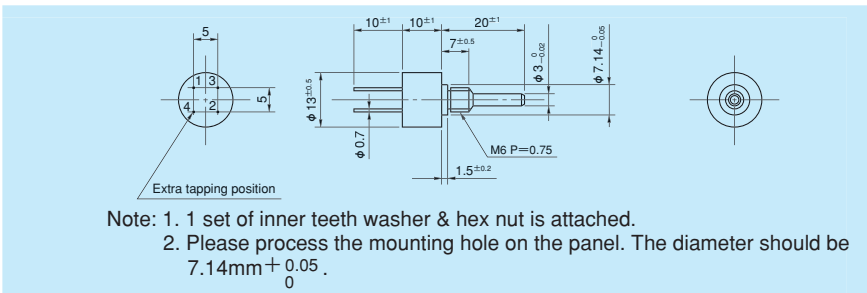

General Specifications

Standard Resistance Values	1k, 2k, 5k, 10k (Ω)
Special Practical Resistance Values	500, 20k, 50k, 100k (Ω)
Total Resistance Tolerance	Standard Class $\pm 15\%$ (L) Precision Class $\pm 10\%$ (K)
Independent Linearity Tolerance	Standard Class $\pm 2.0\%$ Precision Class $\pm 1.0\%$
Resolution	Essentially infinite
Output Smoothness	Within 0.1% against input voltage

Contact Resistance Variation	Within 3% C.R.V.
Power Rating	0.2W
Electrical Travel	$300^\circ \pm 5^\circ$
Mechanical Travel	360° (Endless)
Insulation Resistance	Over 1,000M Ω at 500V.D.C.
Dielectric Strength	1 minute at 500V.A.C.
Starting Torque	Within 2mN · m (20gf · cm)
Resistance Temperature Coefficient	$\pm 400\text{p.p.m./}^\circ\text{C}$
Mass	Approx. 8g

Special Specifications Available

(In the case of the potentiometer with special specifications, the general specifications and environmental specifications may change. Please consult us in advance.)

- Extra tap (Available up to 1 tap)
- Shaft with front and rear extension (Rear shaft with 1mm dia. and 10mm length)
- With stopper (Rotating angle is 310° and stopper strength is 0.3N · m [3kgf · cm])
- Special electrical travel
- Shaft dia. ($\phi 3.175\text{mm}$) & bushing with inch dimension
- Special machining on the shaft

1-Turn ▶ Contact type ▶ Conductive plastic

MODEL FCP12A

- Conductive Plastic
- Servomount
- RoHS Compliant



Model FCP12A

Standard Dimensions

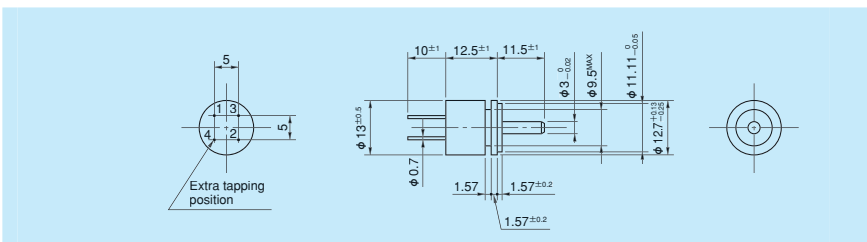

General Specifications

Standard Resistance Values	1k, 2k, 5k, 10k (Ω)
Special Practical Resistance Values	500, 20k, 50k, 100k (Ω)
Total Resistance Tolerance	Standard Class $\pm 15\%$ (L) Precision Class $\pm 10\%$ (K)
Independent Linearity Tolerance	Standard Class $\pm 2.0\%$ Precision Class $\pm 1.0\%$
Resolution	Essentially infinite
Output Smoothness	Within 0.1% against input voltage

Contact Resistance Variation	Within 3% C.R.V.
Power Rating	0.2W
Electrical Travel	$300^\circ \pm 5^\circ$
Mechanical Travel	360° (Endless)
Insulation Resistance	Over 1,000M Ω at 500V.D.C.
Dielectric Strength	1 minute at 500V.A.C.
Starting Torque	Within 1mN · m (10gf · cm)
Resistance Temperature Coefficient	$\pm 400\text{p.p.m./}^\circ\text{C}$
Mass	Approx. 5g

Special Specifications Available

(In the case of the potentiometer with special specifications, the general specifications and environmental specifications may change. Please consult us in advance.)

- Extra tap (Available up to 1 tap)
- Shaft with front and rear extension (Rear shaft with 1mm dia. and 10mm length)
- With stopper (Rotating angle is 310° and stopper strength is 0.3N · m [3kgf · cm])
- Special electrical travel
- Shaft dia. ($\phi 3.175\text{mm}$) & with inch dimension
- Special machining on the shaft