

# MODEL 12HHP-10

- Hybrid
- Bushingmount
- Servomount
- RoHS Compliant

(With metric dimensions)

Multi turn ▶ Contact type ▶ Hybrid



Model 12HHP-10  
(Bushingmount)



Model 12HHP-10  
(Servomount)

## Standard Dimensions

- Bushingmount type
- With lug terminals

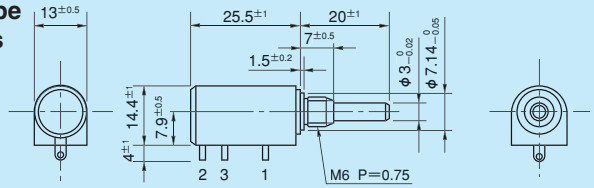

- With pin terminals for p.c. board

### Terminal Holes Layout

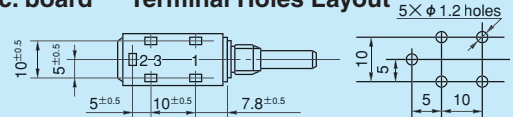

Note: 1. 1 set of inner teeth washer & hex nut is attached.  
2. Please process the mounting hole on the panel. The diameter should be  $7.14\text{mm} +^{0.05}_0$ .

- Servomount type

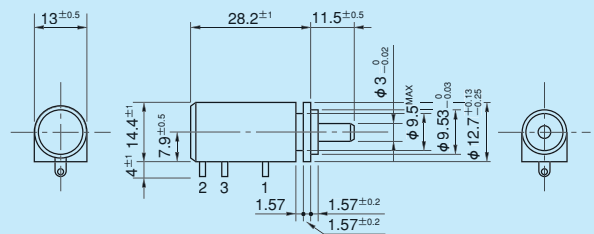

Note: Servomount type with pin terminals for p.c. board is also available.

## Standard Model Numbers

Bushingmount type	
With lug terminals	12HHP-10
With pin terminals for p.c. board	12HHP-10P
Servomount type	
	12HHP-10

## General Specifications

Standard Resistance Values	2k, 5k, 10k, 20k, 50k (Ω)
Total Resistance Tolerance	Standard Class ±10% (K) Precision Class ±5% (J)
Independent Linearity Tolerance	Standard Class ±0.4% Precision Class ±0.1% (±0.2% in case of within 5kΩ)
Resolution	Essentially infinite
Output Smoothness	Within 0.05% against input voltage
Contact Resistance Variation	Within 5% C.R.V.
Power Rating	1.0W
Electrical Travel	3,600° ±5°
Mechanical Travel	3,600° +15° 0°

Insulation Resistance	Over 1,000MΩ at 500V.D.C.
Dielectric Strength	1 minute at 1,000V.A.C.
Starting Torque	Within 3mN · m (30gf · cm) (Bushingmount type) Within 2mN · m (20gf · cm) (Servomount type)
Stopper Strength	Approx. 0.15N · m (1.5kgf · cm)
Appropriate fastening torque of the nut	Within 0.8mN · m (8kgf · cm)
Resistance Temperature Coefficient	±100p.p.m./°C
Mass	Approx. 10g

## Special Specifications Available

(In the case of the potentiometer with special specifications, the general specifications and environmental specifications may change. Please consult us in advance.)

- 5-turn type (S12HHP-5)
- Shaft with front and rear extension (Rear shaft with 0.8mm dia. and 10mm length)
- Special machining on the shaft
- Simple sealed housing (In the case of servomount type, the housing length becomes longer by 1.2mm.)

## Features of Hybrid resistive element

The hybrid resistive element type potentiometer is the upgraded potentiometer, in which the advantages of a wirewound resistive element are combined with those of a film type resistive element.

### Main Features

- High stability of resistance value
- Lower resistance temperature coefficient
- Essentially infinite resolution
- Less resistance variation
- Long life expectancy

### Construction

