

H60JH

● Potentiometer incorporated type ● With a hall effect IC

Nomenclature

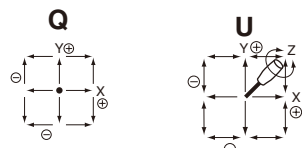
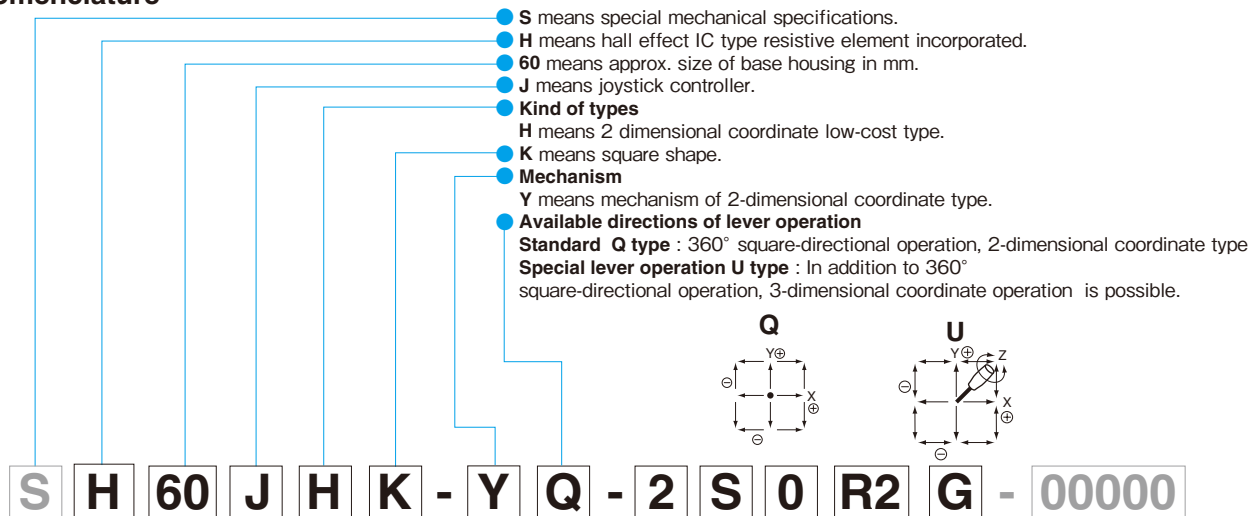

S H 60 J H K - Y Q - 2 S 0 R2 G - 00000

- Number of potentiometers to be incorporated**
 - 0...No potentiometer incorporated. 1...1 potentiometer incorporated.
 - 2...2 potentiometers incorporated.
- Number of output and kind of output characteristic**
 - S...Single output X...Dual cross output P...Dual parallel output
- Switch function (Using output like switch)**
 - 0... No switch function. 1...1 switch function. 2...2 switch function. 3...3 switch function.
 - 4...4 switch function. 5...5 switch function. 6...6 and over 6 switch function.
- Spring return device:**
 - R2...With spring return device for 2 dimensional coordinate type.
- Mounting accessories:**
 - G : With dust proof rubber cover.
 - P : With sub-panel for mounting.
- Special part number:**
 - In the case we produce customized product, we add 4 or 5-digit branch number.

Standard Dimensions

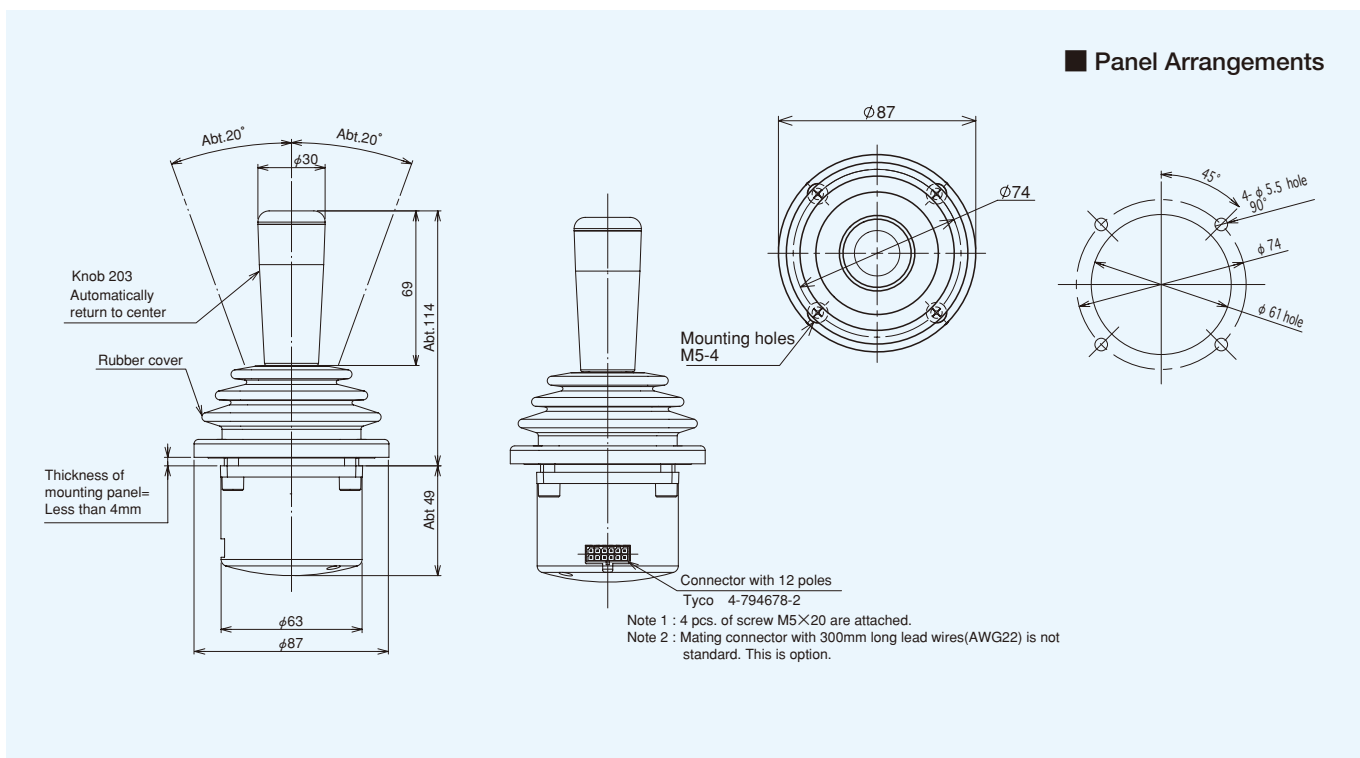

Special Knobs Available



H60JHK-YQ-2S0R2G
(Standard 2-dimensional coordinate type)

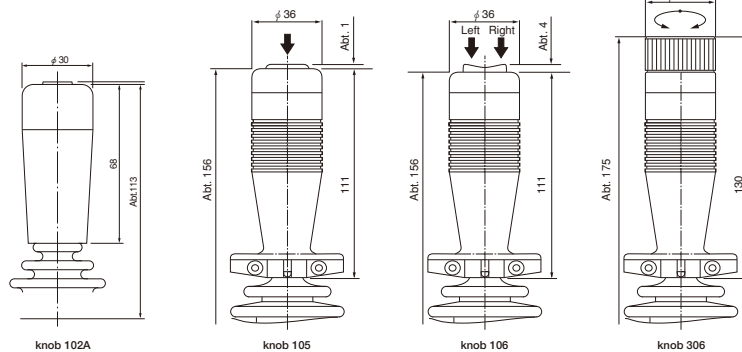

STANDARD SPECIFICATIONS

Mechanical Performance

Controlling range of operating lever	2 dimensional coordinate type X and Y directions : Approx.±20° from center position.
Operating force	Spring return device with directive feeling: Automatically return to center X and Y directions : Approx. 3N~4.5N(300~450gf)
Operating temperature range	-20°C~+60°C
Vibration	10~55Hz 98m/s ²
Shock	294m/s ²
Life expectancy	Approx. 5,000,000 operations
Mass	Approx. 300 g

Electrical Performance

Hall effect IC type resistive element incorporated	<ul style="list-style-type: none"> Applied voltage : D.C. 5V±10 % Effective output : 0.5V~4.5V Electrical rotating angle: Approx. ±20° Independent linearity tolerance : ±3% Load resistance : Over 10KΩ
Dielectric strength	1 minute at 500 V. A.C.
Insulation resistance	Over 1000MΩ at 500 V. D.C.
EMS tolerance	100V/m (80MHz~1GHz 1kHz sine-wave 80%AM modulation)
ESD tolerance	±8kV contact ±15kV air discharge (Based on IEC61000-4-2)

Terminal Connection Diagram

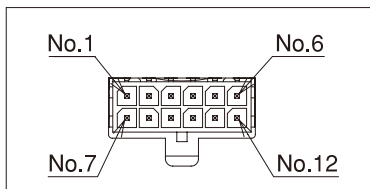

Output Characteristic

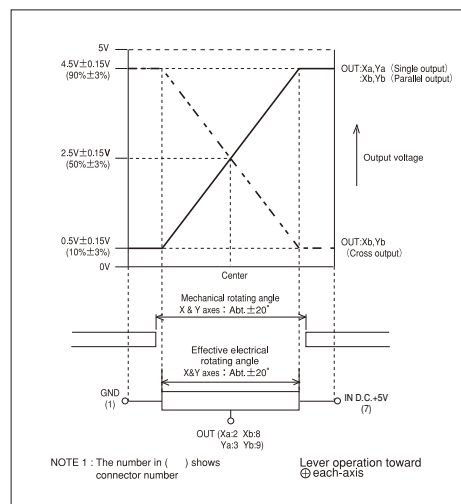

Special Specifications Available

Please see page 55, a table of "Special Specifications Available".
Dual cross and dual parallel output are available.
Knob for 90J model can be mounted on H60JHK model.

Pin numbers for connector

Pin No.	Standard	Cross or parallel output	102A or 105 knob	106 knob	306 knob
No.1(Blue)	GND	GND	GND	GND	GND
No.2(Green)	X OUT-A	X OUT-A	X OUT-A	X OUT-A	X OUT-A
No.3(Yellow)	Y OUT-A	Y OUT-A	Y OUT-A	Y OUT-A	Y OUT-A
No.4(Orange)	—	—	—	—	Z OUT-A
No.5(Red)	—	—	N.O	N.O (Right)	—
No.6(Brown)	—	—	—	N.O(Left)	—
No.7(Red)	IN D.C +5V	IN D.C +5V	IN D.C +5V	IN D.C +5V	IN D.C +5V
No.8(Brown)	—	X OUT-B	—	—	—
No.9(Black)	—	Y OUT-B	—	—	—
No.10(White)	—	—	—	—	(Z OUT-B)
No.11(Gray)	—	—	—	—	—
No.12(Purple)	—	—	COM	COM	—

Note: When the mating connector is required (option), the colors of lead wires are as shown in this table.