



Model MB10-25B



Model MB10-30B

● Standard Dimensions

■ Model MB10-25B

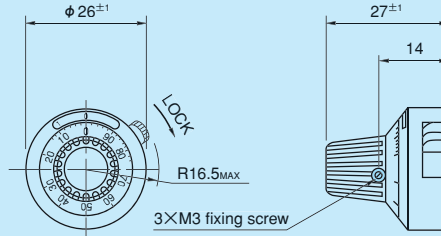

Panel Arrangements

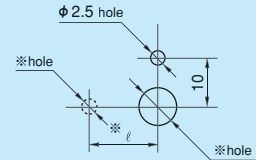

■ Model MB10-30B

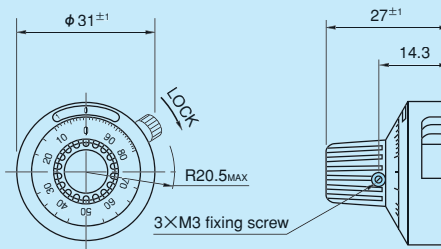

Note: The diameter of ※hole is depending on the diameter of potentiometer to be mounted.

● General Specifications

Model No	Number of Turns-Counting.	Matching Shaft Dia. (mm)		Combinable Helicalohm Pot. (Matching shaft length of 18.5mm)	Lock Device	Operating Temperature Range	Mass (Approx. g)
		Standard	Special				
MBn-25B	3, 5, 10	4, 6	3, 3.175 6.35	10HP 20HP 12HHP 12HP 25HP 20HHP 12HPC 46HD	YES	- 30°C ~ + 60°C	20
MBn-30B	3, 5, 10	4, 6	3, 3.175 6.35		YES	- 30°C ~ + 60°C	20

● Special Specifications Available

- Special colors on housing and spin plate on the top of the knob (Black, etc.)

How to mount MA Series

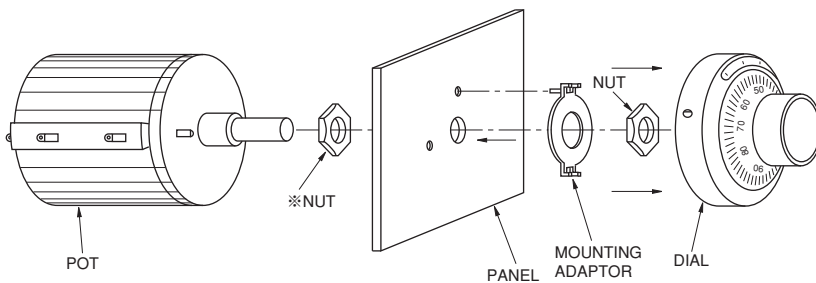

Note: The nut with a mark ※ is not always used. It depends on the kind of potentiometer and the thickness of the panel.

In case of mounting Model **MB** Series counting dials on Helicalohm pot., the mounting adaptor and Helicalohm potentiometer are fixed on the panel according to the illustration given the above. The shaft of the Helicalohm pot. is turned anticlockwise to its limit and

is put into the mounting hole of the dial which is already set at "0". The shaft of the Helicalohm pot. is secured by the screw positioned on the knob of the dial. With this, the mounting is completed.

Mounting Adaptor for use with MB Series

The inner diameters of the mounting adaptor is different to the diameters of the shaft of the potentiometers to be mounted and therefore, please use the mounting adaptor supplied with the dial itself. When mounting the dial on potentiometer, the 2-finger projections (*) of mounting adaptor are inserted in the receiving holes prepared on the base plate of dial firmly, by adjusting the gap between 2-finger projection (*) with a screwdriver. There is possibility where some irregular turns of dial may take place if the adjustment of this gap is insufficient.

For Model MB

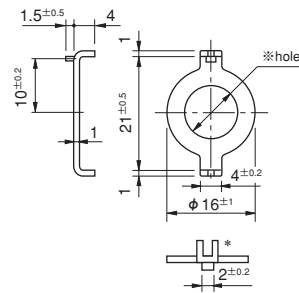

Note: The dimensions of mark ※ are determined by the potentiometer to be mounted.