

MODEL MPH22

● RoHS Compliant

● General Specifications

Model No.	Code of Coupled Motor	Code of Reduction Gear	Coupled Potentiometer			Slipping Torque	Remarks
			Kind of Element	No. of Turns	Pot. Model No.	mN · m (gf · cm)	
MPH22	A B	5~11	Wirewound	1	CP22, CP50	20 to 30 (200 to 300)	Possible to mount turns-counting dials.
				10	22HP-10, 25HP-10	Approx. 50 (500)	
			Hybrid		22HHP-10		
			Conductive Plastic	1	FCP22E, FCP22A, FCP30A, FCP50A	20 to 30 (200 to 300)	—



Model MPH22A7FCP22E



Model MPH22B10FCP22A



Model MPH22A1022HPM-10N

● Rated Specifications of Coupled Motor

Code of Coupled Motor	Input Voltage	Max. Output	Starting Torque	Max. Efficiency	No-Load Speed
A	6V.D.C.	0.26W	0.52mN · m (5.2gf · cm)	65%	19,100 r.p.m.
B	6V.D.C.	0.43W	1.55mN · m (15.5gf · cm)	70%	10,700 r.p.m.

● Characteristics of Reduction Gear (using coupled motor A & B)

Reduction Gear	Reduction Gear Ratio	Response Time (Sec./F.S.) Approx.			
		Motor A (19,100r.p.m.)		Motor B (10,700r.p.m.)	
		1-turn pot.	10-turn pot.	1-turn pot.	10-turn pot.
5	1: 41	—	—	0.6	4.9
6	1: 76	—	—	0.7	6.2
7	1: 141	0.9	7.8	1.0	9.8
8	1: 262	1.2	11.2	1.6	15.7
9	1: 485	1.8	17.9	2.9	28.1
10	1: 900	3.2	31.2	6.0	60.0
11	1: 1,670	5.6	55.7	9.4	93.8

● Specifications of Coupled Potentiometer

For further technical details of potentiometers, please refer to those of each potentiometer section in this catalog.

● Standard Dimensions

■ Model MPH22A FCP22E

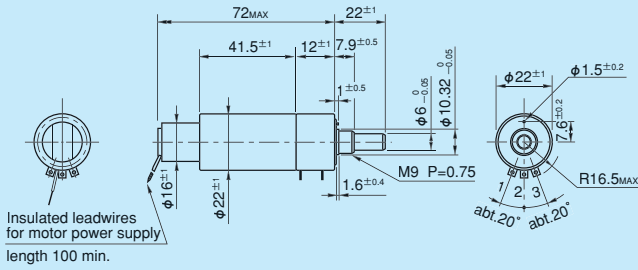

■ Model MPH22A 22HPM-10N

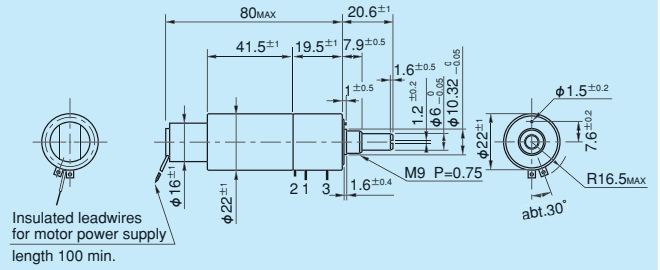

■ Model MPH22B FCP22A

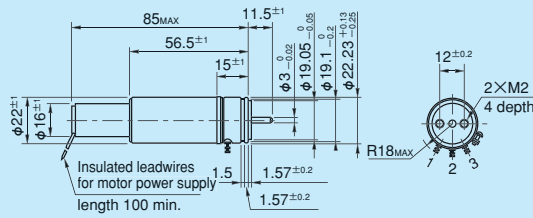

■ Model MPH22B FCP30A

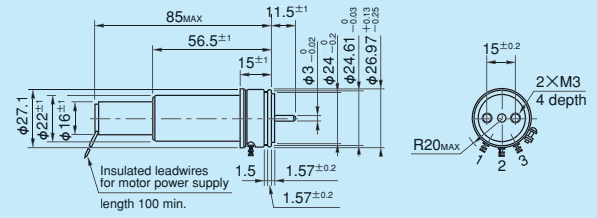

■ Model MPH22B FCP50A

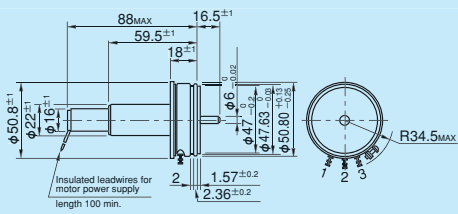

■ Model MPH22B 25HP-10C

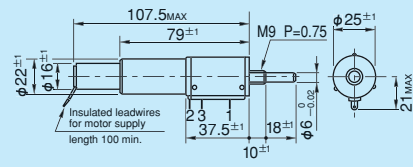

MODEL MPH30

● RoHS Compliant

● General Specifications

Model No.	Code of Coupled Motor	Code of Reduction Gear	Coupled Potentiometer			Slipping Torque	Remarks
			Kind of Element	No. of Turns	Pot. Model No.	mN · m (gf · cm)	
MPH30	A · B	5~11	Wirewound	1	CP22C, CP22	20 to 30 (200 to 300)	—
				10	20HP-10S, 22HPM-10N 25HP-10	Approx. 50 (500)	—
			Conductive Plastic	1	FCP22AC, FCP22E, FCP22A, FCP30A	20 to 30 (200 to 300)	—
				10	20HHP-10S	Approx. 50 (500)	—



Model MPH30A7FCP22E



Model MPH30A5SCP22C



Model MPH30A1022HPM-10N

● Rated Specifications of Coupled Motor

Code of Coupled Motor	Input Voltage	Max. Output	Starting Torque	Max. Efficiency	No-Load Speed
A	6V.D.C.	0.26W	0.52mN · m (5.2gf · cm)	65%	19,100 r.p.m.
B	6V.D.C.	0.43W	1.55mN · m (15.5gf · cm)	70%	10,700 r.p.m.

● Characteristics of Reduction Gear (using coupled motor A & B)

Reduction Gear	Reduction Gear Ratio	Response Time (Sec./F.S.) Approx.			
		Motor A (19,100r.p.m.)		Motor B (10,700r.p.m.)	
		1-turn pot.	10-turn pot.	1-turn pot.	10-turn pot.
5	1: 41	—	—	0.6	4.9
6	1: 76	—	—	0.7	6.2
7	1: 141	0.9	7.8	1.0	9.8
8	1: 262	1.2	11.2	1.6	15.7
9	1: 485	1.8	17.9	2.9	28.1
10	1: 900	3.2	31.2	6.0	60.0
11	1: 1,670	5.6	55.7	9.4	93.8

● Specifications of Coupled Potentiometer

For further technical details of potentiometers, please refer to those of each potentiometer section in this catalog.

Standard Dimensions

Model MPH30 CP22C

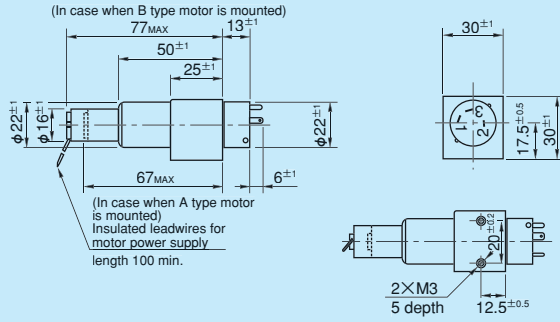

Model MPH30 FCP22A

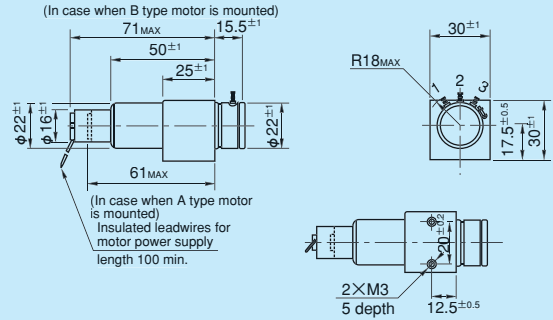

Model MPH30A FCP22E

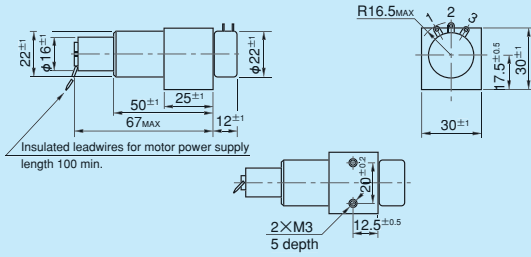

Model MPH30A 22HPM-10N

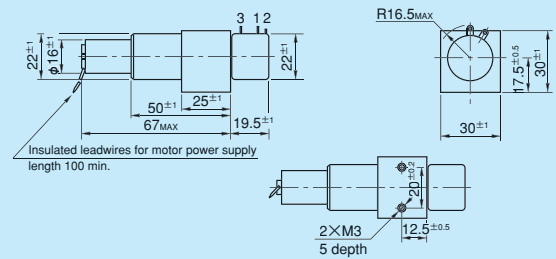

Model MPH30 20HP-10S

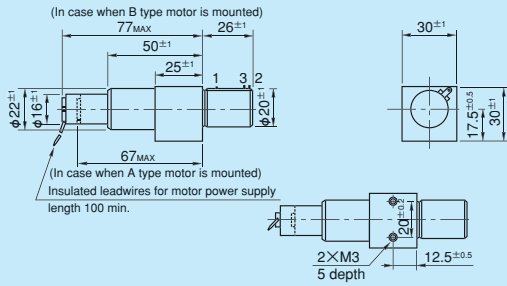

Model MPH30 25HP-10

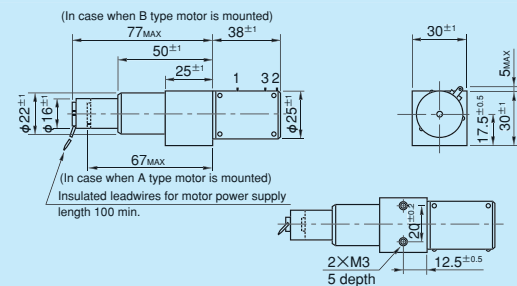

MODEL MPH35

● RoHS Compliant

● General Specifications

Model No.	Code of Coupled Motor	Code of Reduction Gear	Coupled Potentiometer			Slipping Torque	Remarks
			Kind of Element	No. of Turns	Pot. Model No.	mN · m (gf · cm)	
MPH35	C	25~32	Wirewound	1	CP50	Approx. 50 (500)	—
			Conductive Plastic	1	FCP50A		—



Model MPH35C25FCP50A

● Rated Specifications of Coupled Motor

Code of Coupled Motor	Input Voltage	Max. Output	Starting Torque	Max. Efficiency	No-Load Speed
C	6V.D.C.	3.1W	14mN · m (140gf · cm)	87%	8,350 r.p.m.

● Characteristics of Reduction Gear

Reduction Gear	Reduction Gear Ratio	Response Time (Sec./F.S.) Approx.
		1-turn pot.
25	1: 30.7	0.3
26	1: 54.6	0.4
27	1: 97.3	0.7
28	1: 173	1.3
29	1: 308	2.2
30	1: 548	4.0
31	1: 975	7.0
32	1: 1,734	12.5

● Specifications of Coupled Potentiometer

For further technical details of potentiometers, please refer to those of each potentiometer section in this catalog.

● Standard Dimensions

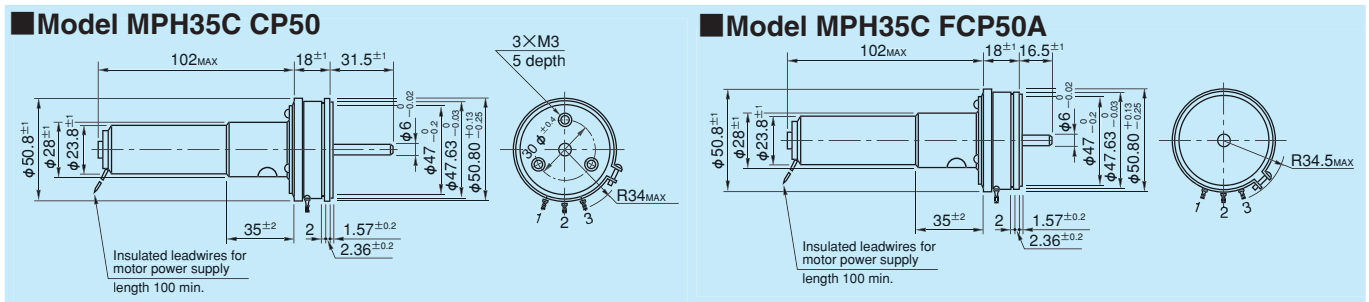

● General Specifications

Model No.	Code of Coupled Motor	Code of Reduction Gear	Coupled Potentiometer			Slipping Torque	Remarks
			Kind of Element	No. of Turns	Pot. Model No.	mN · m (gf · cm)	
MPH46	C	25~32	Wirewound	10	46HD-10	Approx. 50 (500)	Possible to mount turns-counting dials.

● Rated Specifications of Coupled Motor

Code of Coupled Motor	Input Voltage	Max. Output	Starting Torque	Max. Efficiency	No-Load Speed
C	6V.D.C.	3.1W	14mN · m (140gf · cm)	87%	8,350 r.p.m.

● Characteristics of Reduction Gear

Reduction Gear	Reduction Gear Ratio	Response Time (Sec./F.S.) Approx.
		10-turn pot.
25	1: 30.7	2.3
26	1: 54.6	4.0
27	1: 97.3	7.0
28	1: 173	12.5
29	1: 308	22.2
30	1: 548	39.4
31	1: 975	70.1
32	1: 1,734	124.7

● Specifications of Coupled Potentiometer

For further technical details of potentiometers, please refer to those of each potentiometer page in this catalog.

● Standard Dimensions

■ Model MPH46C 46HD-10

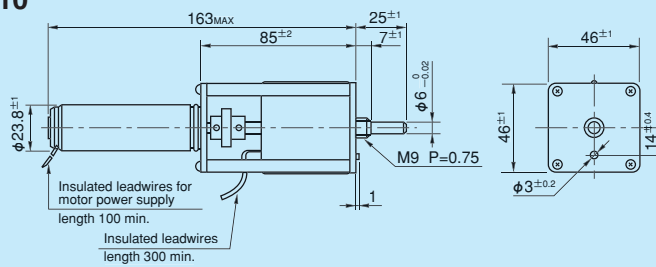

Model MPH46C28 46HD-10