

# MODEL 20HHP

● Hybrid ● Bushingmount ● Servomount ● RoHS Compliant

Multi turn ▶ Contact type ▶ Hybrid



Model 20HHP-10S  
(Bushingmount)



Model 20HHP-10S  
(Servomount)

## Standard Model Numbers

Bushingmount type	
5-turn models	20HHP-5S
10-turn models	20HHP-10S
Servomount type	
5-turn models	20HHP-5S
10-turn models	20HHP-10S

## Standard Dimensions

- Bushingmount type
- With lug terminals

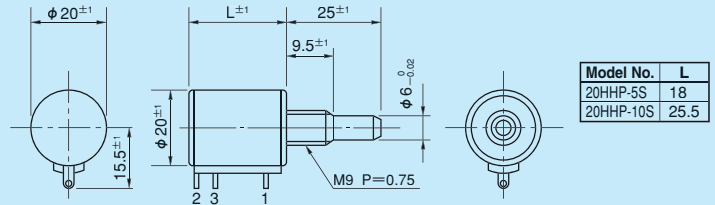

Note: 1 pc. inner teeth washer and 2 pcs. hex nuts are attached.

- Servomount type

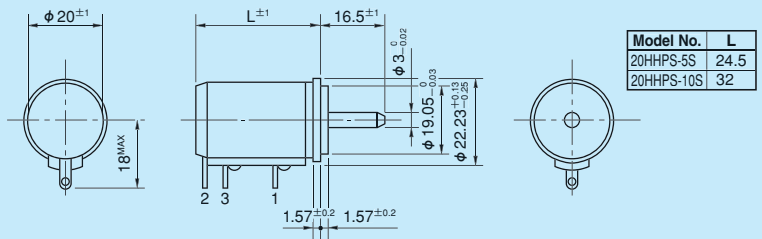

## General Specifications

<b>Standard Resistance Values</b>	1k,2k,5k,10k,20k,50k (Ω) (5-turn) 2k,5k,10k,20k,50k,100k (Ω)(10-turn)	
<b>Total Resistance Tolerance</b>	Standard Class ±10% (K) Precision Class ±5% (J)	
<b>Independent Linearity Tolerance</b>	5-turn	10-turn
	Standard Class	±0.35% ±0.25%
	Precision Class	±0.2% ±0.1%
<b>Resolution</b>	Essentially infinite	
<b>Output Smoothness</b>	Within 0.05% against input voltage (5-turn)	
	Within 0.015% against input voltage (10-turn)	
<b>Contact Resistance Variation</b>	Within 5% C.R.V. (5-turn)	
	Within 3% C.R.V. (10-turn)	
<b>Power Rating</b>	1.0W (5-turn)	
	2.0W (10-turn)	
<b>Electrical Travel</b>	360° × n ± 5° (n: No. of turns)	

<b>Mechanical Travel</b>	360° × n + 10° <sub>0</sub> (n: No. of turns)
<b>Insulation Resistance</b>	Over 100MΩ at 1,000V.D.C.
<b>Dielectric Strength</b>	1 minute at 1,000V.A.C.
<b>Starting Torque</b>	Within 5mN · m (50gf · cm) (Bushingmount type)
	Within 3mN · m (30gf · cm) (Servomount type)
<b>Stopper Strength</b>	Approx. 0.9N · m (9kgf · cm) (Bushingmount type)
	Approx. 0.6N · m (6kgf · cm) (Servomount type)
<b>Resistance Temperature Coefficient</b>	±100p.p.m./°C
<b>Mass</b>	Approx. 20g (5-turn)
	Approx. 25g (10-turn)

## Special Specifications Available

(In case of the potentiometer with special specifications, the general specifications and environmental specifications may change. Please consult us in advance.)

- Extra tap (Available up to 1 tap)
- Multi-ganged (Available up to 2 gangs)
- Shaft with front and rear extension (Rear shaft with 2mm dia. and 10mm length)
- Shaft dia. (φ 6.35mm for 20HHP, φ 3.175mm for 20HHP-5S) & bushing with inch dimension
- Special machining on the shaft
- With slipping-clutch (20mN · m ~ 60mN · m)
- With a limit-switch adaptor
- Simple sealed housing (except servomount type)